



MH Series - Type B

C.R.I. MH series pumps are designed to deliver the best possible hydraulic efficiency. The pump and the motor are connected with a single shaft to eliminate any transmission loss. Wear resistant bearings ensure better hydraulic efficiency and noiseless operation and the pump casing & bracket are made of high quality cast-iron. Dynamically balanced rotor ensure vibration and noise free operation. Shaft of ample size made of quality steel and precisely ground is used for transmitting the rated horsepower. Thermal over load protector is incorporated in single phase motors. These pumps are reliable, easy to install and high end user comfort.

Technical Data

Power input range	: 0.25 kW to 1.8 kW
Speed	: 2900rpm
Version	: Single Phase 230V, 50Hz A.C Supply, Three Phase 380V, 50Hz A.C Supply.
Degree of protection	: IP 55
Insulation class	: F
Type of duty	: S1 (Continuous)
Number of pole	: 2 poles
Nominal Suc. x Del. size	: 1" x 1", 1¼" x 1¼"

Materials of construction

Impeller	: SS 304
Shaft	: SS 420
Diffuser	: Noryl
Pump body	: SS 304
Pump bracket	: Cast iron/Casted S.S
Motor frame	: Aluminium
Mechanical seal	: Carbon and ceramic

Applications

Industrial and domestic water pressure boosting and distribution, small farms, gardens, pumping of clean liquids in industry, car washing.

* In view of continuous development, the information / descriptions / specifications / illustrations are subject to change without notice.

PERFORMANCE CURVES & TABLES

MHB - 2.4

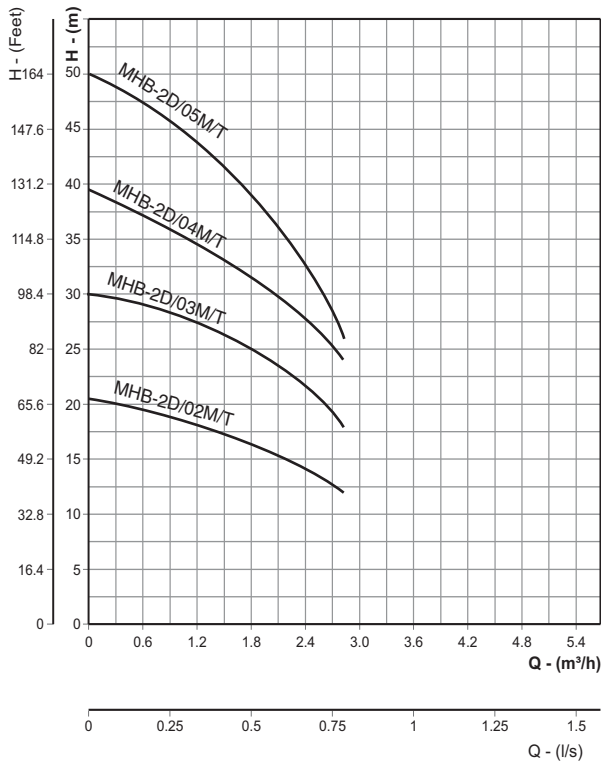

MHB - 3

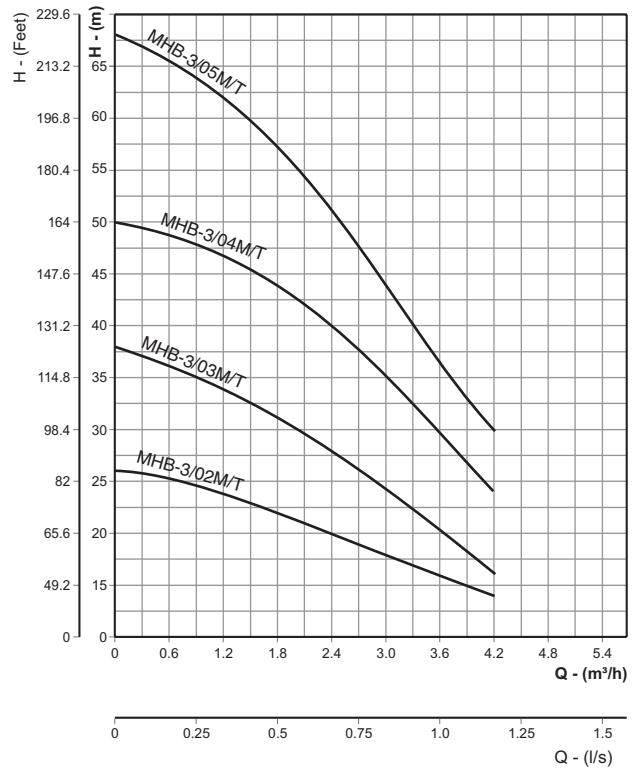

MHB - 2.4

NOMINAL FLOW : 2.4 m³/h

NOMINAL PUMP SIZE : 1" X 1"

Model	Motor Power - P2		l/s m³/h	0	0.17	0.33	0.5	0.67	0.78
	HP	kW		0	0.6	1.2	1.8	2.4	2.82
MHB-2D/02M/T	0.33	0.25	Head in metres	20.5	19.5	18	16.5	14.1	12.2
MHB-2D/03M/T	0.5	0.37		30	29	27.5	25	21.5	18
MHB-2D/04M/T	0.75	0.55		39.5	37	34.6	31.5	27.7	24
MHB-2D/05M/T	1.0	0.75		50	47.5	44	39	32.2	26

MHB - 3

NOMINAL FLOW : 3 m³/h

NOMINAL PUMP SIZE : 1¼" X 1¼"

Model	Motor Power - P2		l/s m³/h	0	0.17	0.33	0.5	0.67	0.83	1.0	1.17
	HP	kW		0	0.6	1.2	1.8	2.4	3	3.6	4.2
MHB-3/02M/T	0.5	0.37	Head in metres	26	25.5	24	22	20	18	15.5	14
MHB-3/03M/T	0.75	0.55		38	36	34	31	28	24.5	20	16
MHB-3/04M/T	1.0	0.75		50	48.5	47	44	40	34.5	28.5	24
MHB-3/05M/T	1.2	0.9		68	65.5	62	57	51.5	44	36	30

M - Single Phase, T - Three Phase

MH SERIES - 50 Hz (TYPE - B)

PERFORMANCE CURVES & TABLES

MHB - 4.2

MHB - 6

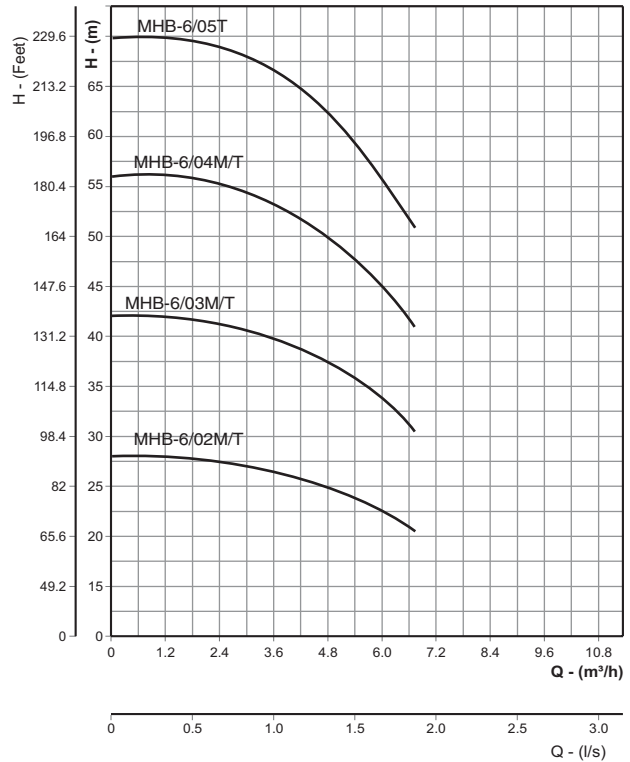
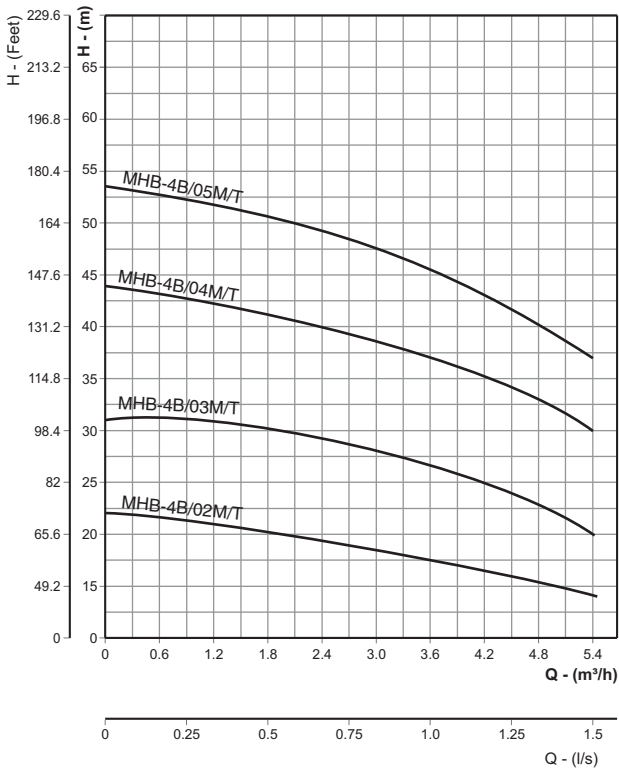

MHB - 4.2

NOMINAL FLOW : 4.2 m³/h

NOMINAL PUMP SIZE : 1" X 1"

Model	Motor Power - P2		l/s m³/h	0	0.33	0.67	1.0	1.33	1.52
	HP	kW		0	1.2	2.4	3.6	4.8	5.46
MHB-4B/02M/T	0.75	0.55	Head in metres	22	21	19.5	17.5	15	14
MHB-4B/03M/T	1	0.75		31	31	29	26.5	23	20
MHB-4B/04M/T	1.2	0.92		44	42	40	37	33	30
MHB-4B/05M/T	1.5	1.1		53.5	52	49.5	45.5	40	37

MHB - 6

NOMINAL FLOW : 6 m³/h

NOMINAL PUMP SIZE : 1¼" X 1¼"

Model	Motor Power - P2		l/s m³/h	0	0.33	0.67	1.0	1.33	1.67	1.9
	HP	kW		0	1.2	2.4	3.6	4.8	6	6.84
MHB-6/02M/T	1.5	1.1	Head in metres	28	28	27.5	26.5	25	22.5	20.5
MHB-6/03M/T	1.8	1.4		42	42	41.5	40	37.5	34	30.5
MHB-6/04M/T	2	1.5		56	56	55.5	53	50	45	41
MHB-6/05T	2.5	1.8		70	70	69	66	62	56	51

M - Single Phase, T - Three Phase

DIMENSIONAL DRAWING & DATA

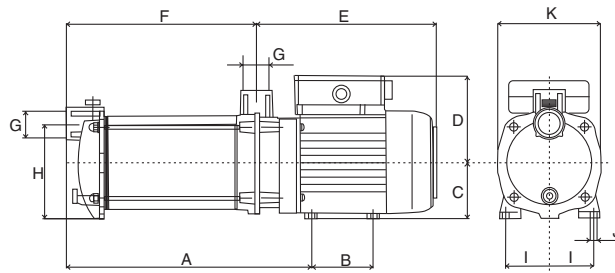

Model	A	B	C	D	E	F	G	H	I	J	K	kg
MHB-2D/02M/T	228	74	63	102	247	166	1"	112	50	10	130	8.2
MHB-2D/03M/T	252	74	63	102	247	190	1"	112	50	10	130	9.0
MHB-2D/04M/T	276	74	63	102	247	214	1"	112	50	10	130	9.8
MHB-2D/05M/T	300	74	63	102	247	238	1"	112	50	10	130	10.6

Model	A	B	C	D	E	F	G	H	I	J	K	kg
MHB-3/02M/T	198	82	71	115	235	142	1 1/4"	130	59	8	140	12
MHB-3/03M/T	219	82	71	115	235	163	1 1/4"	130	59	8	140	12.6
MHB-3/04M/T	240	82	71	115	235	184	1 1/4"	130	59	8	140	14
MHB-3/05M/T	261	82	71	115	235	205	1 1/4"	130	59	8	140	17

Model	A	B	C	D	E	F	G	H	I	J	K	kg
MHB-4B/02M/T	226	82	71	115	230	175.5	1"	130	59	8	140	12
MHB-4B/03M/T	252	82	71	115	230	202	1"	130	59	8	140	12.6
MHB-4B/04M/T	279	82	71	115	230	228.5	1"	130	59	8	140	14
MHB-4B/05M/T	328	82	71	126	251	276	1"	130	59	8	140	17

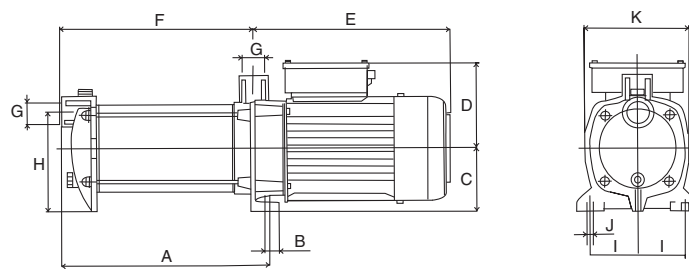

Model	A	B	C	D	E	F	G	H	I	J	K	kg
MHB-6/02M/T	237	18	90	105	275	207	1 1/4"	145	60	11	160	19.0
MHB-6/03M/T	263.5	18	90	105	275	234.5	1 1/4"	145	60	11	160	20.1
MHB-6/04M/T	290	18	90	105	275	262	1 1/4"	145	60	11	160	21.4
MHB-6/05T	337.5	18	90	105	296	289.5	1 1/4"	145	60	11	160	21.6

M - Single Phase, T - Three Phase

* All Dimensions are in mm.

MH SERIES - 50 Hz (TYPE - B)